

Instruction Active dock holder IQC

Whitout Active dock holder – View A

The display is charged with the supplied USB-charger (1) and USB-micro/USB-A cable (2). The cable is connected between the display and the charger which is connected to a wall socket. The display can be used without the charger.

Settings in the IQC-panel

No setting needs to be made, the display is automatically connected wirelessly. .

Active dock holder with USB-charger – View B

The display is charged through the Active dock holder (3). It's connected with the RJ45/USB-A cable (4), 4020657 which is a separate accessory, to the backside of the Active dock holder (3) (RJ45) and to the included USB-charger (1).

Settings in the IQC-panel

[Enable wired communication] = [OFF].

Active dock holder – fixed connection View C

The Active dock holder (3) is connected with a network cable RJ45/RJ45 (5) (not supplied) to the ventilation unit, which takes care of both charging and connection to the unit (6). Connects to the unit's control board, connection marked "+ RC-HMI".

Settings in the IQC-panel

[Enable wired communication] = [ON].

Path in the IQC-panel – View D

To find the setting for communication. Upper left corner "circle with three lines" (7).

[Settings] > [General] >

[Enable wired communication] > [ON/OFF]

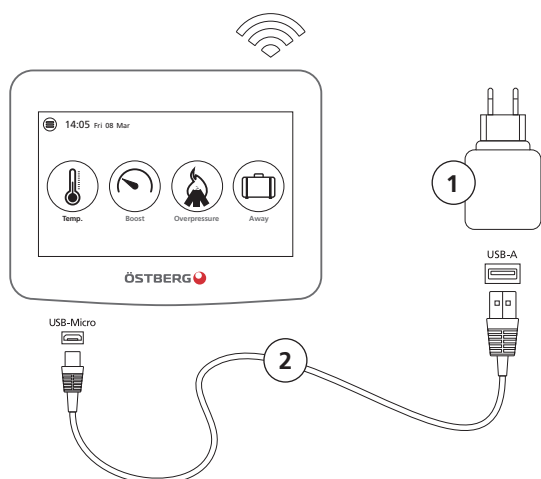

View A – Whitout Active dock holder – with USB-charger.

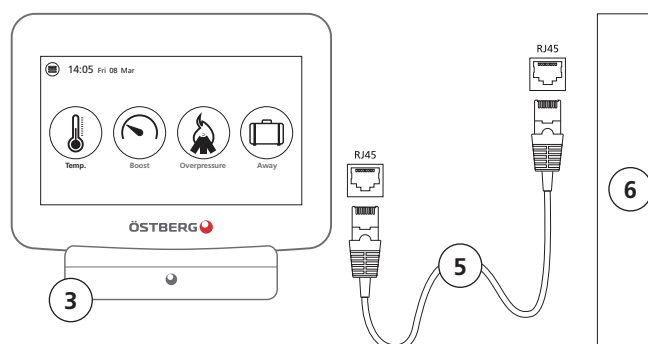

View C – Active dock holder – connected to the ventilation units with network cable.

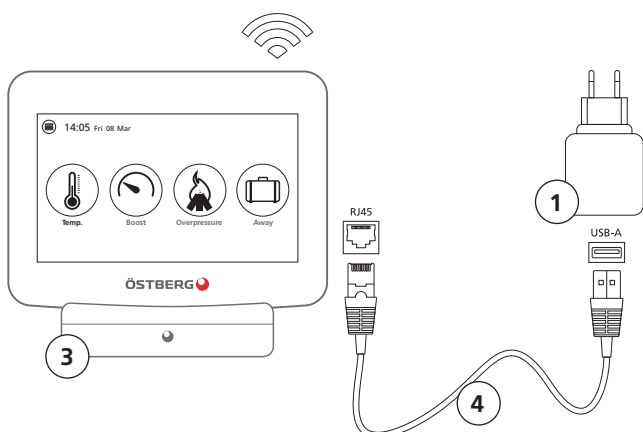

View B – Active dock holder – with USB-charger and RJ45/USB-A cable.



View D – Settings